



DH200

Dissolved Hydrogen meter

Instruction Manual

Thank you for selecting Clean products.
 Before using the meter, relevant person must read and understand the contents of this operation manual. Operation Manual should be kept accessible within the person who use the meters.

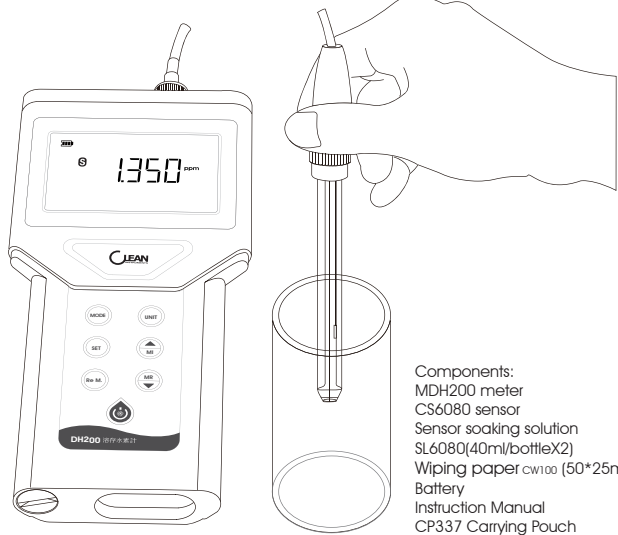

- Components:
 MDH200 meter
 CS6080 sensor
 Sensor soaking solution
 SL6080(40ml/bottleX2)
 Wiping paper CW100 (50*25mm)x3
 Battery
 Instruction Manual
 CP337 Carrying Pouch

www.cleaninst.com
 E-mail: CS@cleaninst.com
 CLEAN INSTRUMENTS CO. LTD
 2F No.140, Zhongxiao St., Zhonghe Dist., New Taipei City ,Taiwan

Display



1. Battery
2. Measuring status stable display. If twinkling, means not stable yet.
3. Measuring value
4. **ppm, ppb** - measuring mode, unit
5. **mV** - Electrode Zero offset

Key function

Key	Description
	Mode switch(Dissolved Hydrogen concentration mode, Reduction Potential mode)
	Unit switch (ppm, ppb)
	Unlock and re-measure
	Power on ON/OFF backlight Long press to Power off

Technical Specifications

Concentration	0.000-2.000 ppm
measuring range	0ppb-2000 ppb
mV measuring range	-2000mV-2000mV
Resolution	0.001ppm
Accuracy	±0.002ppm
Battery	2*1.5V 7AAA battery
Working Environment	-5 C -60 C , Relative Humidity<90%
Dimensions	94*190*35mm (W*L*H)
Weight	250g

Function Setting

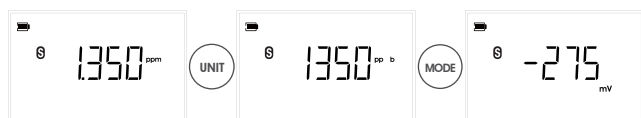

Press **UNIT** to switch unit (ppm, ppb),

Press **MODE** to switch from Dissolved Hydrogen concentration mode to Reduction Potential mode



With the sensor soaking solution display: 0.000ppm.

Battery

Use the coin to remove the battery cover by following the “-” direction. Insert 2*7AAA batteries in the battery compartment with the correct Positive and Negative poles. Tight the battery cover by following the “+” direction.

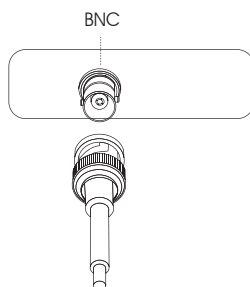
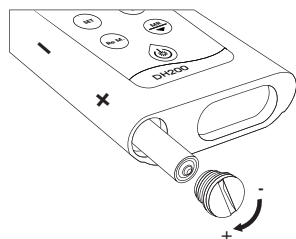

Electrode Installation

The direction of the red dot marker on the Electrode and the salient point on the unit should be the same when install the electrode to the unit. Remove the electrode by pulling out the clamp on the electrode.

Shell

If the meter accidentally touches water or other fluids, please wipe it clean immediately. The meter function is not affected usually. But if affected and cannot use (possibly because of the battery cover is not tight and penetrated by water), please contact our company or CLEAN local customer service center. They will be very glad to help you.

Power on/off and Backlight

Power on: Short press power on/off key to start the meter. The whole screen displayed within 1 second.

Power off: Long press the power on/off key to power off the meter.

Auto power off in 10 minutes if without any operation.

LCD backlight: Short press  key to control if turn on the backlight or not.

Electrode using and maintenance

[Notice]

1. Please keep the metallic diaphragm always clean. Make sure the sensor protection bottle is filled up with soaking solution. Note: Other solutions or tap water can not be used as protection solution.
 2. Please rinse off the sensor tip with clean water after each use and cover the protection bottle back. Please also check the volume of the soaking solution. If not enough, please be sure to add more.
 3. If there is smudginess and mineral elements adhere on the metallic diaphragm, random numbers may get displayed. Rinse off the tip with clean water and place it back in sensor protecting cap. Make sure it displays “0” before shutting off power.
 4. If there is smudginess and mineral elements adhere on the metallic diaphragm, the responsive time will be deduced and readings might drop. Please use the wiping paper to polish the electrode metallic diaphragm. Make sure the sensor tip is very clean.
- After cleaning, please must keep the sensor tip in soaking solution. If the reading is not 0.000ppm when in soaking solution, please change the sensor.
4. Life expectancy of an electrode depends on frequency of use. Generally, it should be replaced in 1 year. Generally, it should be replaced in 1 year.



CS6080
Electrode metallic diaphragm

Cleaning order of the electrode metallic diaphragm:

1. Spin off the sensor protection bottle (please pay attention not to spill out the soaking solution).
2. Hold the wiping paper (with the rough surface up) and drop a few drops of water on the paper.
3. Horizontally contact the bottom of the metallic diaphragm with the wiping paper which having water on it. Rub rotating as you writing the Arabic numeral “8” for around 10 times.
4. Rinse off the tip with clean water and place it back in sensor protecting cap. Make sure it displays “0” before shutting off power.

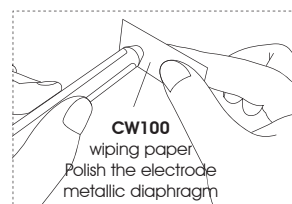

CW100
wiping paper
Polish the electrode metallic diaphragm

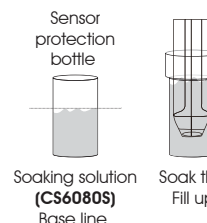

Sensor protection bottle
Soaking solution (CS6080S)
Base line

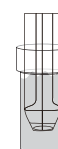

Soak the sensor in the bottle.
Fill up but don't overflow.

General Information

Warranty

CLEAN Instruments warrants this product to be free from significant deviations in material and workmanship for a period of one year from the date of purchase. If repair is necessary and has not been the result of abuse or misuse within the warranty period, please return to CLEAN Instruments and amendment will be made without any charge. CLEAN Instruments Customer Service Center will determine if product problem is due to deviations or customer abuse. Out of warranty products will be repaired on a charge basis.

Return Of Malfunction Instruments

Authorization must be obtained from CLEAN Instruments Customer Service Center to issue a RIR number before returning items for any reason. When applying for authorization, please include date requiring the reason of return. Instruments must be carefully packed to prevent damage in shipment and insured against possible damage or loss. CLEAN Instruments will not be responsible for any damage resulting from careless or insufficient packing. Warning: Damage as a result of inadequate packaging is the User / distributor's responsibility. Please follow the guidelines below before transporting.

Guidelines Or Returning Unit For Repair

Use the original packaging material if possible, when transporting back the unit for repair. Otherwise wrap it with bubble pack and use a corrugated box for better protection. Include a brief description of any faults suspected for the convenience of Customer Service Center, if possible. If there are any questions, feel free to contact our Customer Service Center or distributors.