

Instruction Manual

Thank you for selecting Clean products.
Before using the meter, relevant person must read and understand the contents of this operation manual. Operation Manual should be kept accessible within the person who use the meters.

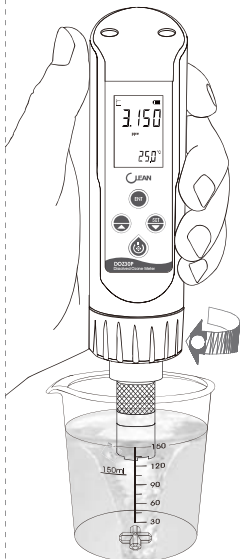

DOZ30P tester body
CS6932 sensor
1.5VAAA battery *1
Electrode electrolyte-(ESDOZ6932 30mL)
Replacement membrane cap*2- (MS6932CAP)
Instruction Manual



www.cleaninst.com
Customer Service: CS@cleaninst.com

TABLE OF CONTENTS

1. Product Overview	2
2. Precautions	3
3. Configuration and LCD Introduction	3
4. Key Panel	4
5. Battery and electrode installation	4
6. Before measurement	5
7. Sample measurement	5
8. Set up	6
9. Specification	7
10. Package	7
11. General Information	8

1. Product Overview

The measurement range of DOZ30P is up to 20.00 ppm. It can selectively measure dissolved ozone and is not easily disturbed by other substances in dirty water.

-2-

2. Precautions

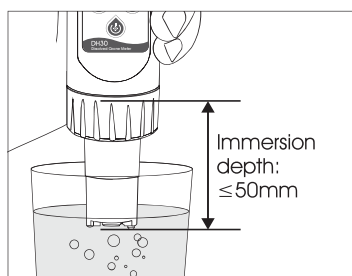

Please wipe up the electrode with clean tissue or cloth before using.
Do not throw or beat, squash or twist the tester deliberately.
Do not expose to the direct sunlight or put in high humidity or high temperature environment.

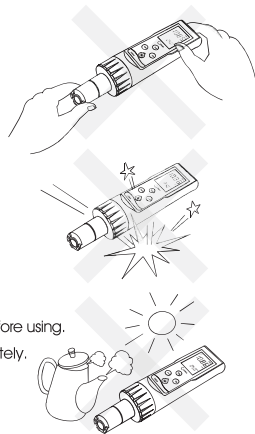

3. Configuration and LCD Introduction

- Set up
 - Data stabilized
 - Low battery indicator
 - Measurement mode
 - Auto Lock function
 - Auto Lock after data stabilized
 - Measuring value
- ppm,mV - measuring mode, unit

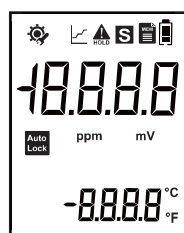

4. Key panel

Key instruction

Short press: Short press means release the key once after pressing.
(If there is no mark out below, default it as Short press)
Long press: Long press means press the key for 3 seconds and then release it
Hold: Hold means not release the key and accelerate after a certain time. Not release the key until the value is set as needed.

	Long press to Power ON/OFF Short press to ON/OFF backlight Escape key when in mV mode and setting up
	Long press to enter into mV mode Increment values or scroll through the next options available
	Data setting Decrement values or scroll through the next options available
	Confirm key Press to unlock in Auto lock mode

5. Battery and Electrode installation

Unscrew the screw cap by following the arrow direction, slightly unplug the electrode, install the battery (pay attention to the anode and cathode of the electrode).
Then install back the electrode and the screw cap.
Low battery prompt is at the top of the screen when battery power is low. (You can refer to the LCD INTRODUCTION). Please change the same model battery.

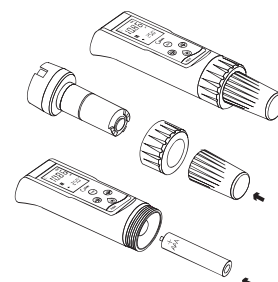

-3-

-4-

6. Before measurement



1. Make sure that the permeable membrane cap is not stained or damaged.
2. Fill 50% full electrolyte and slowly screw up the membrane cap.

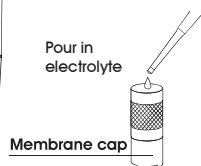

Note:
If the reading value is above 0.020 ppm after polarization in the air, user should refill or change the electrolyte of the sensor.

7. Sample measurement

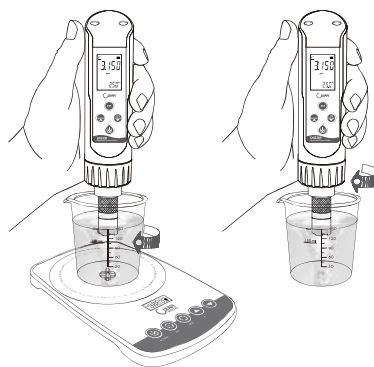

Take appropriate samples and measure them with DOZ30P.

To obtain more stable reading value, it is recommended that users use magnetic stirrer or manual stirring measurement. +

-5-

8. Set up

In measurement mode, press "SET" to enter SET UP. Corresponding icons will be displayed. You can press "SET" and "CAL" to select the menu and then press "ENT" to confirm. Press "SET" or "CAL" to set up and confirm by press "ENT". You can also press "ENT" to back to measurement mode.

The Set up menu as follow:

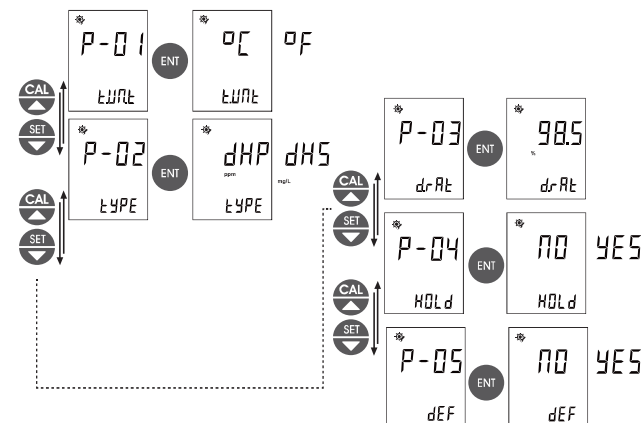

P01: Unit of the temperature. You can select between °C and °F.

P02: Unit of the measurement. You can select between ppm and mg/L.

P03: Readout adjustment/Calibration:

Compared with DPD method, users can enlarge or reduce the reading value as a function of calibration.

In case you got a 1.00 ppm value from DPD method, and from the same water sample, the reading value from DOZ30P is 1.10 ppm for example, you can input 90.9% in P-03 to finish calibration.

Calculation: $1.00/1.10 = 90.9\%$ (Input range: 50.0%~200.0%).

P04: Auto Lock. You can select "ON" or "OFF" to auto lock the data once stabilized.

P05: Factory defaults. You can select to revert to factory defaults.

-6-

9. Specifications

Concentration measuring range	0.000 - 20.00 ppm (mg/L)
Resolution	0.001 ppm (mg/L)
Accuracy	±1.5 %
Temperature	°C, °F optional
Temp. Range	0 - 75.0 °C / 32 - 140 °F
Auto Temp. Compensation	0 - 75 °C
Temperature	°C, °F optional
Sensor	CS6932 replaceable dissolved ozone sensor
LCD	20*30 mm multi-line crystal display with backlight
Backlight	ON/OFF optional
Auto power off	10 minutes without key be pressed
Power	1x1.5V AAA7 battery
Working Environment	0°C - 75°C, Relative Humidity: <90%
Protection	IP67
Dimensions	(HXWDX) 185 X 40 X 48mm
Weight	95g

10. Package

Size: L*W*H 210*100*65mm
Weight: 350g

DOZ30P tester body
CS6932 sensor
1.5VAAA battery*1
Electrode electrolyte - (ESDOZ6932 30mL)
Replacement membrane cap* 2 - (MS6932CAP)
Instruction Manual

-7-

11. General Information

Warranty

CLEAN Instruments warrants this product to be free from significant deviations in material and workmanship for a period of one year from the date of purchase. If repair is necessary and has not been the result of abuse or misuse within the warranty period, please return to CLEAN Instruments and amendment will be made without any charge. CLEAN Instruments Customer Service Center will determine if product problem is due to deviations or customer abuse. Out of warranty products will be repaired on a charge basis.

Return Of Malfunction Instruments

Authorization must be obtained from CLEAN Instruments Customer Service Center to issue a RIR number before returning items for any reason. When applying for authorization, please include date requiring the reason of return. Instruments must be carefully packed to prevent damage in shipment and insured against possible damage or loss. CLEAN Instruments will not be responsible for any damage resulting from careless or insufficient packing.

Warning: Damage as a result of inadequate packaging is the User / distributor's responsibility.

Please follow the guidelines below before transporting.

Guidelines Or Returning Unit For Repair

Use the original packaging material if possible, when transporting back the unit for repair. Otherwise wrap it with bubble pack and use a corrugated box for better protection. Include a brief description of any faults suspected for the convenience of Customer Service Center, if possible. If there are any questions, feel free to contact our Customer Service Center or distributors.

-8-